

Fujikura CT50

NEW

The most robust cleaver



Fiber Cleaver

Fujikura CT50

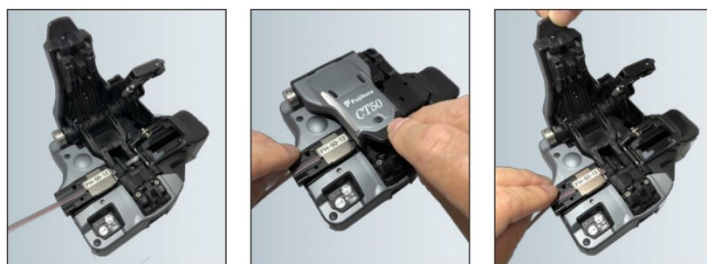

- Applicable for up to 12-fiber cleaving
- Automatic cleaving blade rotation via wireless communication
- User replaceable fiber clamps and cleaving blade
- Blade life up to 60,000 cleaves
- Wide lever opening angle allows easy fiber placement
- Single-action operation including fiber scrap collection

Newly Installed



Fujikura

Fujikura CT50

SPECIFICATIONS

Description	CT50
Applicable optical fiber	Silica optical fiber
Fiber count	Up to 12
Cladding diameter	125 μm
Coating diameter	160 to 900μm 2 to 3mm cord and drop cable
Cleaving length	AD-10-M24
	AD-50
	Fiber holder
	5mm to 20mm (coating diameter =250μm) 10mm to 20mm (coating diameter > 250μm)
	10mm (from the edge of FH:13mm)
Cleaving angle*1	Typical 0.5 degrees
Blade life	Typical 60,000 fibers
Wireless connectivity	Wireless technical standard:Bluetooth®4.1 LE*2 OS : Android 5.0 or above, iOS 8.0 or above (iPhone6 above)
Power supply	AAA (LR03) dry battery: 2pc
Dimensions	120(W) x 95(D) x 58(H)mm
Weight	300g
Operation condition	0 to 95% RH and 0 to 40°C (non-dew)
Storage condition	0 to 95% RH and -40 to 80°C (non-dew)
Resistance features*3	Shock: 76cm (30inch) all directions drop
	Dust resistance: Exposure to dust (0.1 to 500μm dia. Alumina Silicate)
	Rain resistance: H=10mm/hr for 10min

*1 The optical fiber type, the blade condition or the operating environment may affect the cleaving angle. Since the measuring device has been changed from an interference microscope to a fusion splicer, this specification value is now higher than that of the previous model (CT-30).

*2 The Bluetooth wireless connection of this product is not guaranteed to work with all smartphones or other devices.

*3 The shock resistance test does not guarantee the product will not be damaged under these conditions.

• Bluetooth and Bluetooth logo is a registered trademark of Bluetooth SIG, Inc.



STANDARD PACKAGE

Description	Model No.	Qty.
Fiber plate	AD-10-M24	1pc
Fiber plate	AD-50	1pc
Spacer	SPA-CT08-10	1pc
Carrying case	CC-37	1pc
Hexagonal wrench	HEX-01	1pc
Instruction manual	M-CT50-E	1pc

OPTIONAL ITEMS

Description	Model No.
Blade	CB-08
Arm set	ARM-CT50-01
Dust box	FDB-05
Blade rotary wheel	BRW-CT08-01
Side cover	SC-CT50-01

STANDARD PACKAGE

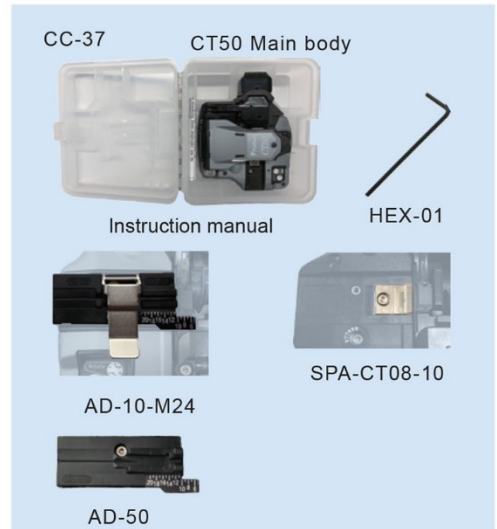

OPTIONAL ITEMS



FIBER HOLDERS

Description	Model No.
Applicable fiber holder	FH-60-xxx
	FH-70-xxx
	FH-100-xxx



Please visit our web site!

<https://www.fusionsplicer.fujikura.com>



Facebook
<https://www.facebook.com/FujikuraFusionSplicers>
Twitter
<https://twitter.com/fujikurasplicer>

Specifications and descriptions are subject to change without prior notice. ©2018 Fujikura Ltd.

Fujikura Ltd.

1-5-1, Kiba, Koto-ku, Tokyo 135-8512, Japan
Phone:+81-3-5606-1164 Fax:+81-3-5606-1534 <http://www.fujikura.com>

Fujikura Asia Ltd.

438A Alexandra Road, Block A Alexandra Technopark #08-03 Singapore 119967
Phone:+65-6-278-8955 Fax:+65-6-278-0965 <http://www.fujikura.com.sg>

Fujikura Europe Ltd.

C51 Barwell Business Park, Leatherhead Road, Chessington, Surrey KT9 2NY, UK
Phone:+44-20-8240-2000 Fax:+44-20-8240-2010 <http://www.fujikura.co.uk>

AFL

260, Parkway East, Duncan, SC29334, USA
Phone:+1-800-235-3423 Fax:+1-800-926-0007 <http://www.aflglobal.com>

Fujikura (China) Co., Ltd.

7th Floor, Shanghai Hang Seng Bank Tower, 1000 Lujiazui Ring Road, Pudong New Area, Shanghai, 200120 CHINA
Phone:+86-21-6841-3636 FAX +86-21-6841-2070

913-10-0842-142-95-01

Printed in Japan 1805-1811-0-FJK