

1 Factory default settings

CAUTION

Failure to follow these instructions could result in damage to the product and void the factory warranty. The accuracy of the door preparation is critical for the proper functioning and security of this product. Misalignment can cause performance degradation and a lessening of security.

NOTES

1. Master PIN code: Default master PIN code is "123456". Please modify it after installation.
 2. User PIN code number: User PIN codes can be set up with PIN code numbers.
 - 00-05: Normal user PIN code number
 - 06: Temporary user PIN code, it will be deleted automatically after one time use. The temporary user PIN code can not unlock under the safe mode.
 3. User PIN code: User PIN codes can be set up only through master PIN code. Each PIN code has only one PIN code number.
 4. Card: Maximum 43 cards can be registered with card numbers(00-46).
 5. Fingerprint: Maximum 43 fingerprints can be registered with fingerprint numbers(00-46).
- *Please refer to below item numbers in manual to set up the product with master PIN code and use it.

Model	How to set up	How to open
RS-1	1. Add user PIN code 2. Add user fingerprint 4. Delete user PIN code 5. Delete user fingerprint	Pin code.....6.1.1 Fingerprint.....6.1.2
RS-5	1. Add user PIN code 2. Add user fingerprint 3. Add user card 4. Delete user PIN code 5. Delete user fingerprint 6. Delete user card	Pin code.....6.1.1 Fingerprint.....6.1.2 Card.....6.1.3

Product picture

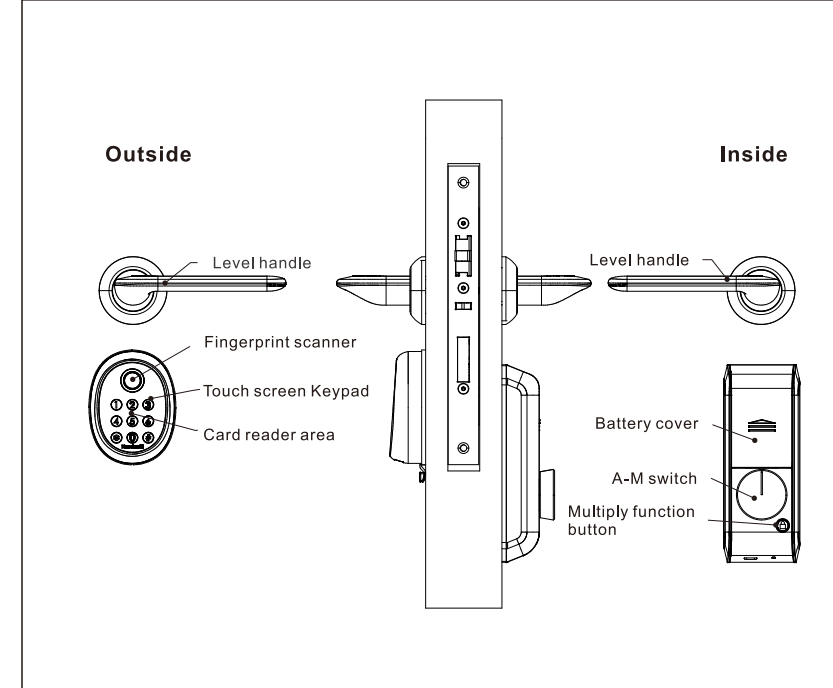

Bottom of outside escutcheon

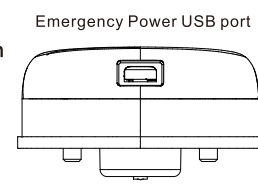

Mechanical key hole

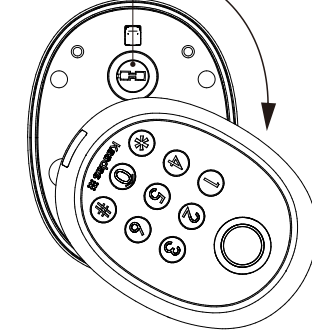

Mechanical key hole

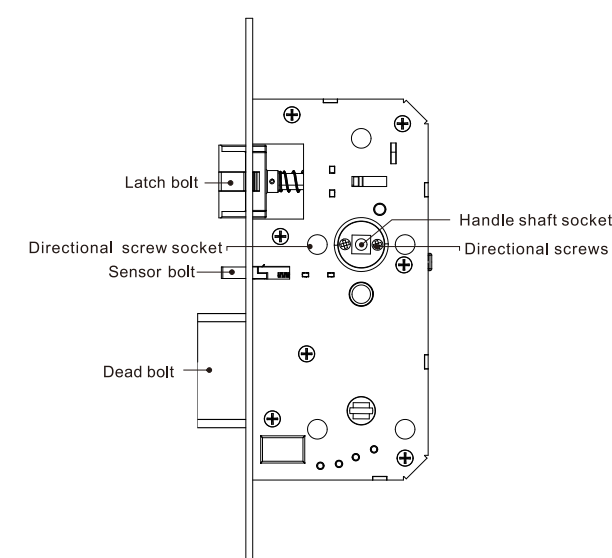

Default mortise

Mechanical key



NOTE

Pictures of components above are just for reference. They can be different according to your model.

2 Packing list and explosive view

Please check all parts carefully according to the following list after opening the box

Number	Item number	Quantity	Remark
1	Outside escutcheon	1	
2	Inside escutcheon	1	
3	Mortise	1	
4	Screw package	1	
5	User manual	1	
6	Warranty card	1	
7	Mechanical key	2	2 pieces of emergency key
8	Strike plate	1	
9	Installation template	1	
10	User card	2	
11	Network module	1	Optional

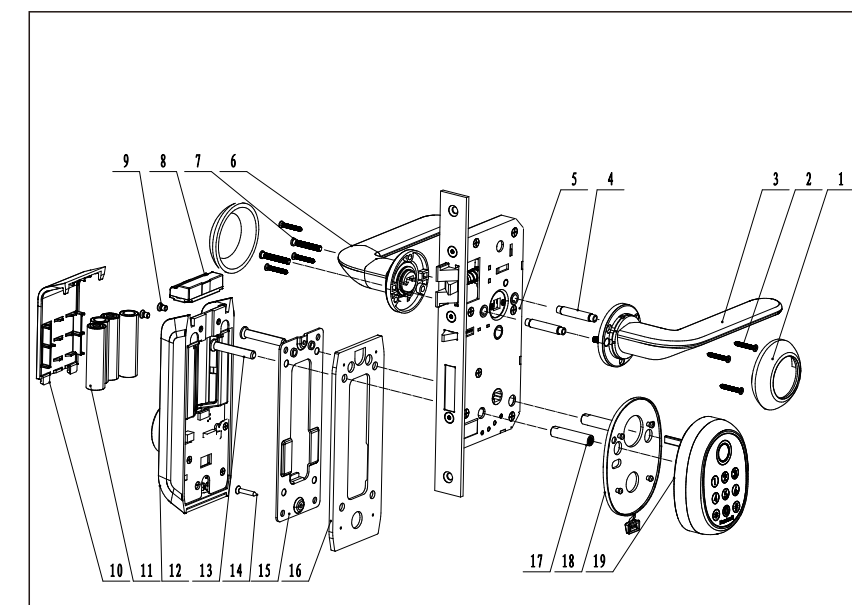

- | | |
|------------------------------------|---|
| 1. Rose cover(2) | 12. Inside escutcheon |
| 2. Fixed screws of level handle(6) | 13. M5 screw |
| 3. Outside lever handle(1) | 14. M3 screw |
| 4. M4 through bolt guide(2) | 15. Inside mounting plate |
| 5. Mortise(1) | 16. Inside escutcheon silicon filler piece |
| 6. Inside level handle(1) | 17. M5 through bolt guide(2) |
| 7. M4 screws(2) | 18. Outside escutcheon silicon filler piece |
| 8. Network module(Optional) | 19. Outside escutcheon |
| 9. M4*6 screws(2) | |
| 10. Battery cover(1) | |
| 11. Battery | |

3 Prepare lock for installation

3.1 Confirm door direction

This product can be installed on 4 types of door directions

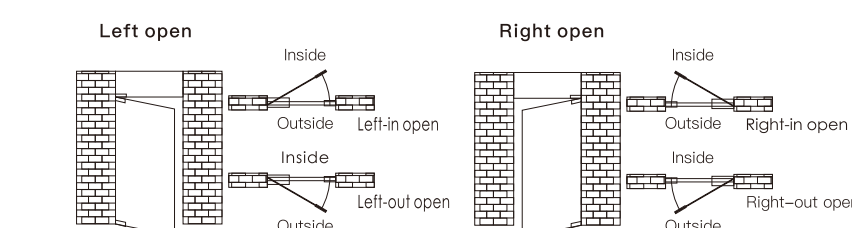

3.2 Confirm door thickness

1. Measure your door thickness and confirm the screw package fits your door.
2. Factory default screw package is for 40-60mm door thickness, if it doesn't fit your door, please contact our dealer.

3.3 Fix directional screws

Change side of directional screws.

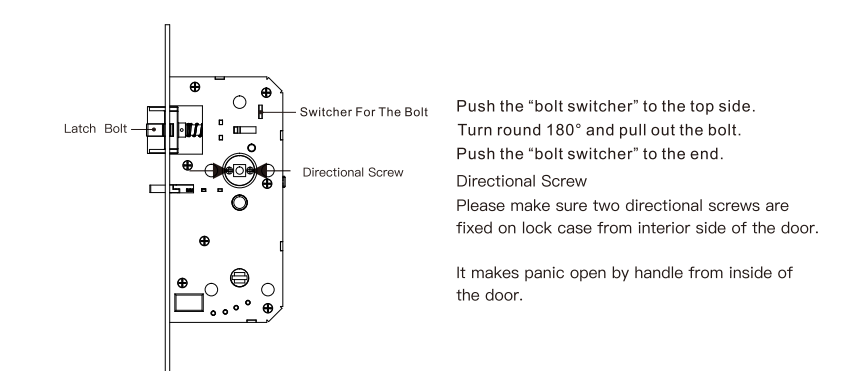

4 Installation

4.1

Drill holes according to the installation template, and put the mortise inside the door

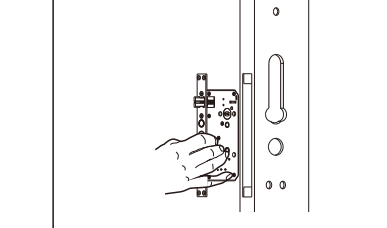

4.2

Fix mortise screws

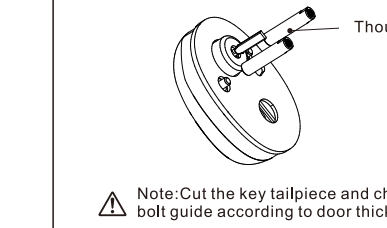

4.3

Install the through bolt guide and fix them on the outside escutcheon

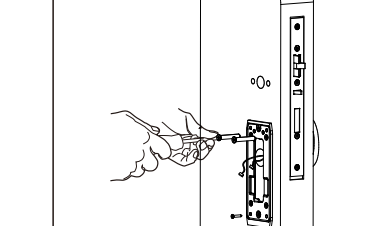

4.4

Put connecting cable through the door, insert the key tailpiece into the hole on the mortise, keep the outside escutcheon close to the door.

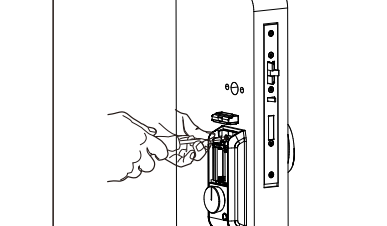

4.5

Fix the mounting plate with screws.

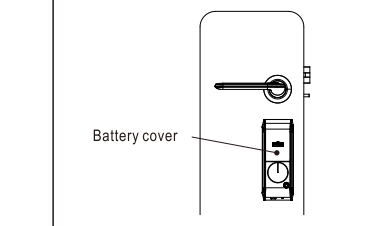

4.6

Install the through bolt guide, spring and shaft handle into the lever handle into the handle hole, fix the screws and rose cover.

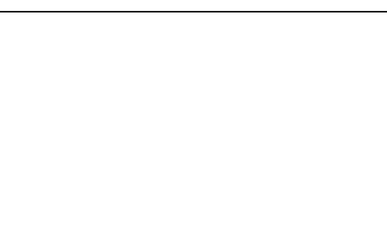

4.7

Fix the two mounting screws



4.8

Turn the level handle and key to test whether the installation is successfully



4.9

Install batteries, battery cover, strike plate, then installation is finished

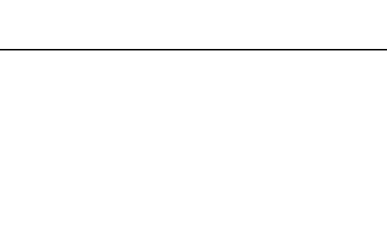

NOTE

Please test whether the door can open and close smoothly after installation

5 How to set up product

5.1 How to enter Master mode

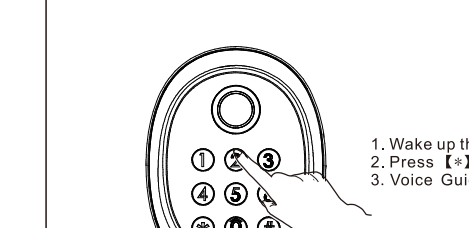

1. Wake up the touchscreen with your palm.
2. Press [4] twice, input Master PIN code, and press [4]
3. Voice Guide: "Enter the management mode."

5.2 Menu index in Master Mode

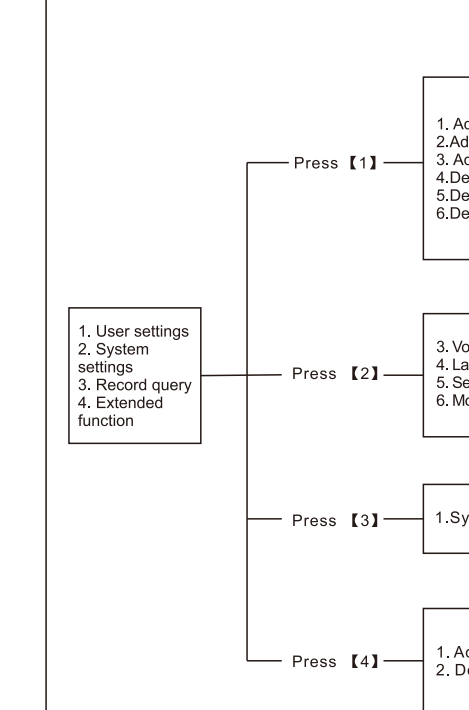

NOTE

1. You can operate following the voice guide.
2. Master and user PIN code have 6-12 digits, the default master PIN code is [123456].
3. Input 400- [4] to check serial number of this lock.

纸张: 128g铜版纸双面单黑印刷

工艺: 风琴7折, 折后尺寸125*265mm

User settings

Add User PIN code

1 + 1 Enter Master Mode, press [1] to enter user settings, press [1] to add user PIN code

1 2 3 # Input User PIN code number (00-99), press "*" to confirm

4 5 6 # Input 6-12 digits of User PIN code and press [4], input the same user PIN code again and press [4] to confirm. Voice Guide: "Add success"

0 0 # Input 00-05: Normal user PIN code
06: Temporary user PIN code. It will be deleted automatically after one time use.

Add user fingerprint

1 + 2 Enter Master Mode, press [1] to enter user settings, press [2] to add user fingerprint.

1 2 3 # Input user PIN code number (00-99), press [1] to confirm

4 5 6 # Put user finger on the fingerprint scanner 4 times according to the Voice Guide. Voice Guide: "Add success"

1. Please remove your fingerprint and scan again.
2. Add success.

Add user card(Optional)

1 + 3 Enter Master Mode, press [1] to enter user settings, press [3] to add User Card

1 2 3 # Input user card number (00-99), press [1] to confirm

4 5 6 # Put User Card close to the card reader area until hearing the sound "D". Voice guide: "Add success".

Delete user PIN code

1 + 4 Enter Master Mode, press [1] to enter user settings, press [4] to delete user PIN code

1 Press [1] for deleting single PIN code

1 2 3 # Input PIN code number that you want to delete, press [4] to confirm. Voice guide: Deletion succeed

4 5 6 # Input 6-12 digits of User PIN code and press [4], input the same user PIN code again and press [4] to confirm. Voice Guide: "Add success"

0 0 # Press [2] for deleting all PIN code. Voice guide: Deletion succeed.

Delete user fingerprint

1 + 5 Enter Master Mode, press [1] to enter user settings, press [5] to delete user fingerprint

1 Press [1] for deleting single fingerprint

1 2 3 # Input fingerprint numbers that you want to delete, press [5] to confirm. Or put your finger on the fingerprint scanner until hearing the sound "D". Voice guide: Deletion succeed

4 5 6 # Press [2] for deleting all PIN code. Voice guide: Deletion succeed.

Delete user card(optional)

1 + 6 Enter Master Mode, press [1] to enter user settings, press [6] to delete user card

1 Press [1] for deleting single user card

1 2 3 # Input card number that you want to delete, press [6] to confirm. Or put card on the card reader area until hearing the sound "D". Voice guide: Deletion succeed

4 5 6 # Press [2] for deleting all user card. Voice guide: Deletion succeed.

User settings

Voice Settings

2 + 3 Enter Master Mode, press [2] to enter System settings, press [3] to enter voice setting.

1 Press [1] to set voice mode, the system will have voice guide.

2 Press [2] to set silent mode, the system will have no operating voice.

Language Setting

2 + 4 Enter Master Mode, press [2] to enter system settings, press [4] to enter language setting

1 Press [1] to choose Chinese, the voice guide will be in Chinese

2 Press [2] to choose English, the voice guide will be in English.

Open mode settings

2 + 5 Enter Master Mode, Press [2] to enter System settings, press [5] to set up open mode.

1 Press [1] to choose normal mode, Opening way: PIN code, fingerprint or card

2 Press [2] to choose safe mode: PIN code+fingerprint (PIN code+card or fingerprint+ card), double verification.

Modify master PIN code

2 + 6 Enter Master Mode(refer to item 5.1), press [1] to enter user settings, press [6] to modify master PIN code.

1 2 3 # Input new master PIN code (6-12 digits), press [4] to confirm and input new PIN code again, press [4] to confirm. Voice guide: setting succeed.

System query

3 Under Master Mode, press [3] to enter system query.

1 Press [1], the Serial Number query will be read.

6 How to use the lock

6.1 Under normal mode

6.1.1 PIN code opening

1. Wake up the keypad with palm
2. Input added user PIN code, press [4] to confirm.
3. Push down the level handle to unlock

Note Users can input fake PIN code before or after correct user PIN code. The PIN code can not be over 30 digits including the fake PIN code.

6.1.2 Fingerprint opening

1. Put your finger(added) on the fingerprint scanner.
Voice guide: "Verification succeed" after hearing the sound "D".
2. Push down the level handle to unlock

6.1.3 Card opening

1. Put card (added) on the card reader area.
2. Push down the level handle to unlock

6.2 Under safe mode

Under safe mode, it needs double verification to open the door

(1) PIN code + fingerprint
(2) PIN code + card
(3) Fingerprint + card

6.3 Mechanical key unlock

When batteries wear off, forget user PIN code, or system error, you can use mechanical key to unlock

Keyhole

1. Push up the keypad, insert the mechanical key into the key hole and turn the key, then you can turn level handle to unlock

6.4 Automatic/ Manual Mode

A-M Mode switch

1. A-M switch is on the inside escutcheon.
2. When the mark is on up side means Auto mode, when you close the door, the main bolt will throw out automatically.
3. When the mark is on right direction means Manual Mode, the main bolt will not throw out automatically.

6.5 Dead locking and Privacy Mode button

Multifunction button

1. Press "Multifunction button" once, main bolts will throw out to lock the door no matter in Automatic Mode or Manual Mode when the door is closed.
2. Hold "Multifunction button" Sec (Privacy mode): main bolt will throw out to lock the door no matter in Automatic Mode or Manual Mode when the door closed, and the keypad will be locked down, the lock can be unlocked only by key from outside or unlock from inside by push down level handle.

6.6 Dead lock

6.5.1 Dead locking from outside

Under automatic mode, dead bolt will throw out in 1.5 second after door closed. Voice guide: "Door closed"

Automatic locking

6.5.2 Dead locking from inside

Under manual mode, press "multifunction button" to lock the door, voice guide: "Door closed"

Manual mode

6.5.3 Privacy mode

Hold "Multifunction button" (Privacy mode): main bolt will stretch out to lock the door no matter in automatic mode or manual mode when the door closed, the keypad will be locked, only can unlock by key or unlock from inside.

6.5.4 Emergency unlock

Press "Multifunction button" twice to unlock from inside when you can not unlock from inside by handle

Multifunction button

Note 1. Under normal mode, if continuously inputting wrong PIN code or fingerprint or card(optional) 10 times, the keypad will be locked for 5 minutes. Under locked condition, you can exit it by taking out battery and put them back, or you can unlock by other ways.
2. Under safe mode, continuously inputting any two kinds of opening ways among password/ fingerprint/ optional) 10 times, the system will be locked for 5 minutes. Under this condition, password/fingerprint(optional function) can't be inputted, you can exit it by taking out battery and put them back to unlock system.

6.6 Defense Mode ON/OFF

Defense button

1. ON: After closing the door from outside, keypad lights up, press "*" button. Voice guide: "Defense ON". This lock will alarm when someone opens the door from inside.
2. OFF: Defense mode will remove since there are someone open the lock in any ways from outside

6.7 Restore factory settings

In case of forgetting master PIN code, you can remove inside escutcheon cover, keep pressing the reset button for over 5 seconds. Voice guide: "Your lock has restored to factory settings". It means the lock has been restored to factory settings successfully.

Extend function

Note All the PIN codes/fingerprints/cards added before will be cleared after restore to factory settings. The master PIN code will restore as (123456). Please modify master PIN code as soon as possible.

6.8 How to use emergency power USB port

Emergency power USB port

If the batteries is wearing out, you can connect Micro-USB 5V to provide power. Insert the cable into the emergency power USB port, then open the door in normal way.

Note When the power is lower than 4.8V, system will sound voice guide: "Low power, please replace the battery" after every time you open the lock successfully. In this situation, please change batteries ASAP. (do not use different types of batteries together or old and new batteries together).

6.9 How to change batteries

Battery life

In the battery box you can put 6 AA 1.5V alkaline batteries maximum. It can be used for over one year as the standard used 10 times a day. (Battery life is relative to user's using habits, using environment, optional function and so on.)

2. Voice guide of replacing batteries
When hearing "Low power, please replace the battery", please change batteries as soon as possible.

6.10 Extended functions(optional)

Extended function port

Extended functions could be activated by network module. Please contact our dealers for more details.